



FIM TOWER
UL. UJAZDOWSKA, WARSAW

CLIENT : ORCO PROPERTY GROUP.
DESIGN : CHRISTIAN BIECHER, ARCHITECT ;
WITH STEPHANIE SUPELJAK, VIRGILE ROGER, ELIE BARRAU, ARCHITECTS ;
ALEXIS COUSSEMENT, LIGHTING DESIGNER ;
ARCORA, BUILDING SERVICES ENGINEERS.

NET AREA : 25 000 M².

DESCRIPTION : REFURBISHMENT OF A 30 FLOORS OFFICE TOWER.

COMPLETION : 2009.

3D IMAGES : CBA.

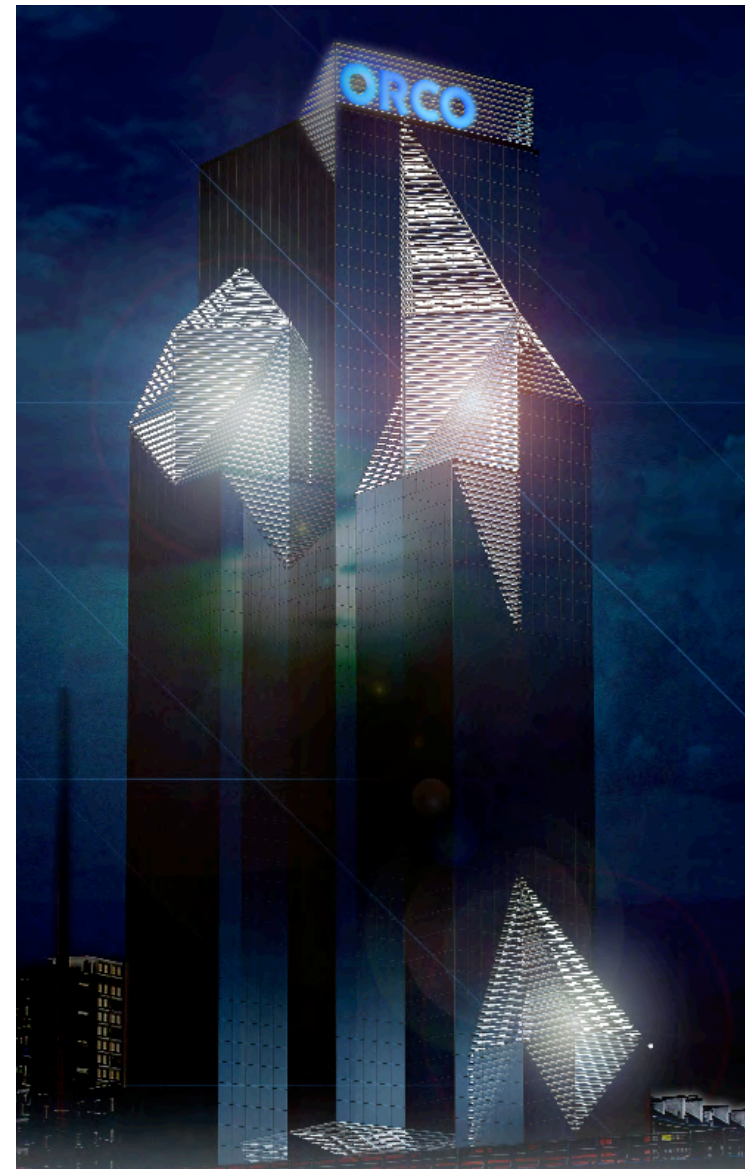

FIM TOWER
UL. UJAZDOWSKA, WARSAW

